

REV	LOCATIONS	DESCRIPTION	DATE	REVISER	APPD
1	△	Update view structure and materials	24/DEC/21	MATT	CHERRY
2	△	Update view structure	18/AUG/22	MATT	CHERRY
3		Add Circuit Size Layout page	05/JUN/25	MATT	LEO

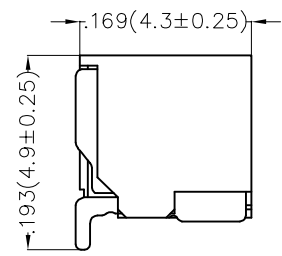
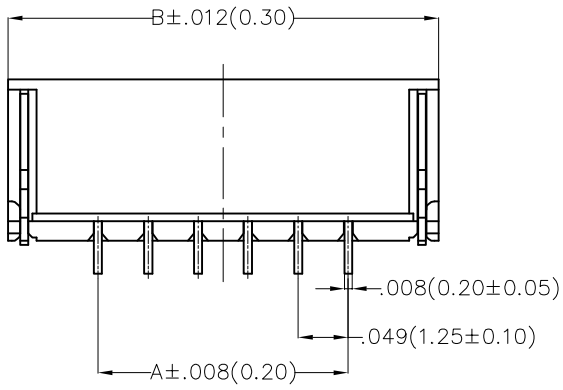
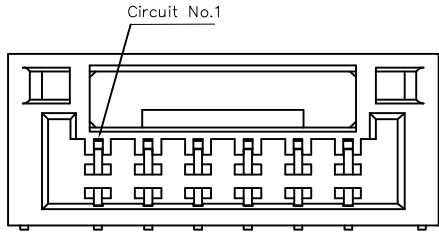

Electrical

Current Rating: 1.0A AC(rms)/DC
 Voltage Rating: 50V AC(rms)/DC
 Contact Resistance: 30 mΩ Max
 Insulation Resistance: 100 MΩ MIN
 Withstanding Voltage: 100V AC r.m.s
 Temperature Range—Operating: -25°C ~ +85°C
 Material and Plating
 Housing: PA9T(UL 94V-0)
 Contact Pin: Phosphor Bronze/ Tin plated
 Solder Tab: Phosphor Bronze/ Tin plated
 Mates With: FHG12507 Series

Circuits (n)	Part No.	Dimensions(in/mm)	
		A	B
2	FWF12514-S02B24W5M	.049(1.25)	.226(5.75)
3	FWF12514-S03B24W5M	.098(2.50)	.276(7.00)
4	FWF12514-S04B24W5M	.147(3.75)	.325(8.25)
5	FWF12514-S05B24W5M	.197(5.00)	.374(9.50)
6	FWF12514-S06B24W5M	.246(6.25)	.423(10.75)
7	FWF12514-S07B24W5M	.295(7.50)	.472(12.00)
8	FWF12514-S08B24W5M	.344(8.75)	.522(13.25)
9	FWF12514-S09B24W5M	.394(10.00)	.571(14.50)
10	FWF12514-S10B24W5M	.443(11.25)	.620(15.75)
11	FWF12514-S11B24W5M	.492(12.50)	.669(17.00)
12	FWF12514-S12B24W5M	.541(13.75)	.719(18.25)
13	FWF12514-S13B24W5M	.591(15.00)	.768(19.50)
14	FWF12514-S14B24W5M	.640(16.25)	.817(20.75)
15	FWF12514-S15B24W5M	.689(17.50)	.866(22.00)

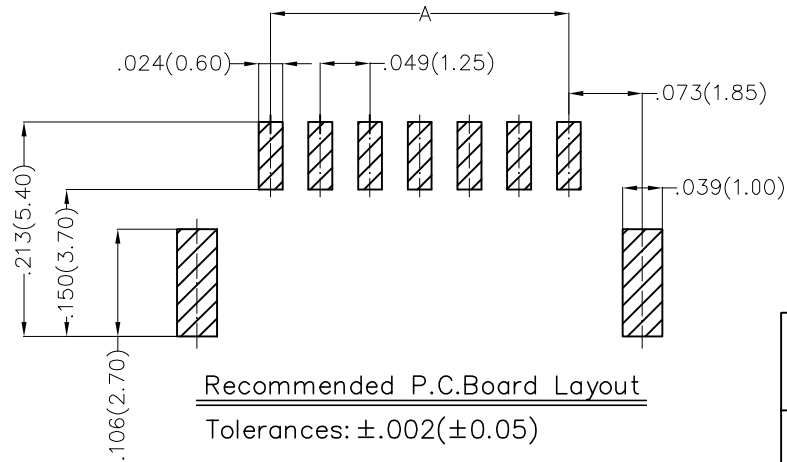

Recommended P.C.Board Layout
 Tolerances: ±.002(±0.05)

Ordering Information

FWF 125 14 — S XX B 2 4 W5 M
 1 2 3 4 5 6 7 8 9 10

1	Category FWF-Wafer	2	Series Number 125-Pitch1.25mm	3	Distinction No. 14	4	Row Option S-Single Row	5	Circuits XX
6	Entry Angle B-90° Angle	7	Plating 2-Tin Plated	8	Material-Resin 4-PA9T	9	Color-Resin W5-White	10	Packaging M-Reel

THIRD ANGLE PROJECTION		GENERAL TOLERANCES (UNLESS SPECIFIED)		APPROVE BY	DATE	PART NO.	ITEM NO.	TXGA Building Technology Cornerstone
DESIGN UNITS Inch (metric)	SCALE 5:1	SIZE A4	X±.012(0.30)	X'±5'	FRANK	FWF12514-SXXB24W5M	FWF12514	
			X.XX±.008(0.20)	.X'±2'	JACOB	TITLE Wire to Board (Wafer) Pitch 1.25mm 90° Angle (SMT)	THIS DRAWING CONTAINS INFORMATION THAT IS PROPRIETARY TO TXGA INDUSTRIAL ELECTRONICS(S.Z)CO.,LTD AND SHOULD NOT BE USED WITHOUT WRITTEN PERMISSION	
			X.XX±.006(0.15)	.XX'±1'	CHERRY	DATE 8/JUL/13		

1 2 3 4 5 6 7 8

REV	LOCATIONS	DESCRIPTION	DATE	REVISER	APPD

Circuit Size Layout

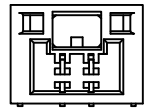

2 Circuits

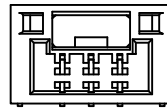

3 Circuits

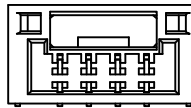

4 Circuits

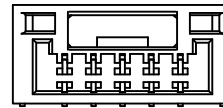

5 Circuits

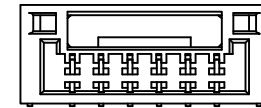

6 Circuits

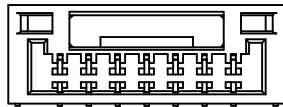

7 Circuits

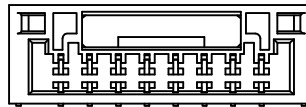

8 Circuits

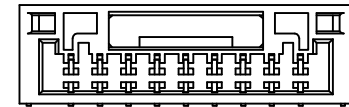

9 Circuits

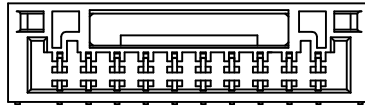

10 Circuits

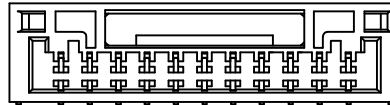

11 Circuits

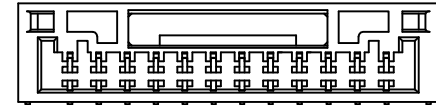

12 Circuits



13 Circuits

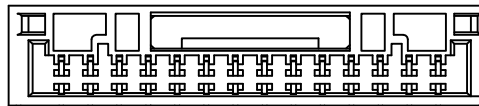

14 Circuits

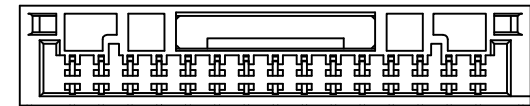

15 Circuits

<p>THIRD ANGLE PROJECTION</p>	<p>GENERAL TOLERANCES (UNLESS SPECIFIED)</p>		<p>APPROVE BY</p> <p>FRANK</p>	<p>DATE</p> <p>8/JUL/13</p>	<p>PART NO.</p> <p>FWF12514-SXXB24W5M</p>	<p>ITEM NO.</p> <p>FWF12514</p>	<p>Building Technology Cornerstone</p>
	<p>DESIGN UNITS</p> <p>Inch (metric)</p>	<p>X.±.012(0.30)</p> <p>X.X±.008(0.20)</p> <p>X.XX±.006(0.15)</p> <p>X.XXX±.004(0.10)</p>	<p>X'.±5'</p> <p>.X'±2'</p> <p>.XX'±1'</p> <p>.XXX'±0.5'</p>	<p>CHECKED BY</p> <p>JACOB</p>	<p>DATE</p> <p>8/JUL/13</p>	<p>TITLE</p> <p>Wire to Board (Wafer)</p> <p>Pitch 1.25mm 90° Angle (SMT)</p>	
<p>SCALE</p> <p>5:1</p>	<p>SIZE</p> <p>A4</p>	<p>DRAWN BY</p> <p>CHERRY</p>		<p>DATE</p> <p>8/JUL/13</p>	<p>THIS DRAWING CONTAINS INFORMATION THAT IS PROPRIETARY TO TXGA INDUSTRIAL ELECTRONICS(S.Z)CO.,LTD AND SHOULD NOT BE USED WITHOUT WRITTEN PERMISSION</p>		

1 2 3 4 5 6 7 8

A
B
C
D
E
F

A
B
C
D
E
F